

## 6211-I1 ADSL2+ Router Quick Installation Instructions

Document Number 6211-A2-GZ10-10

December 2004

### Installation

1. Connect your ADSL line to the port labeled LINE on the rear panel of the device.
2. For routers with a phone port, optionally connect your telephone to the port labeled PHONE.
3. Connect your PC or a LAN:
  - Use the supplied Ethernet cable to connect your PC directly to the router. Connect one end of the Ethernet cable to the port labeled LAN on the router and connect the other end to the Ethernet port of your computer.
  - Alternatively, use the supplied USB cable to connect your PC directly to the router. Connect one end of the USB cable to the port labeled USB on the router and connect the other end to a free USB port on your PC. Install the USB drivers as described in the user's guide on the CD.
  - If your LAN has more than one computer, you can attach one end of an Ethernet cable to a hub or a switch and the other to the LAN port of the router. Either a crossover or straight-through Ethernet cable can be used.
4. Connect the AC power adapter to the POWER connector on the back of the device and plug the adapter into a wall outlet or power strip.

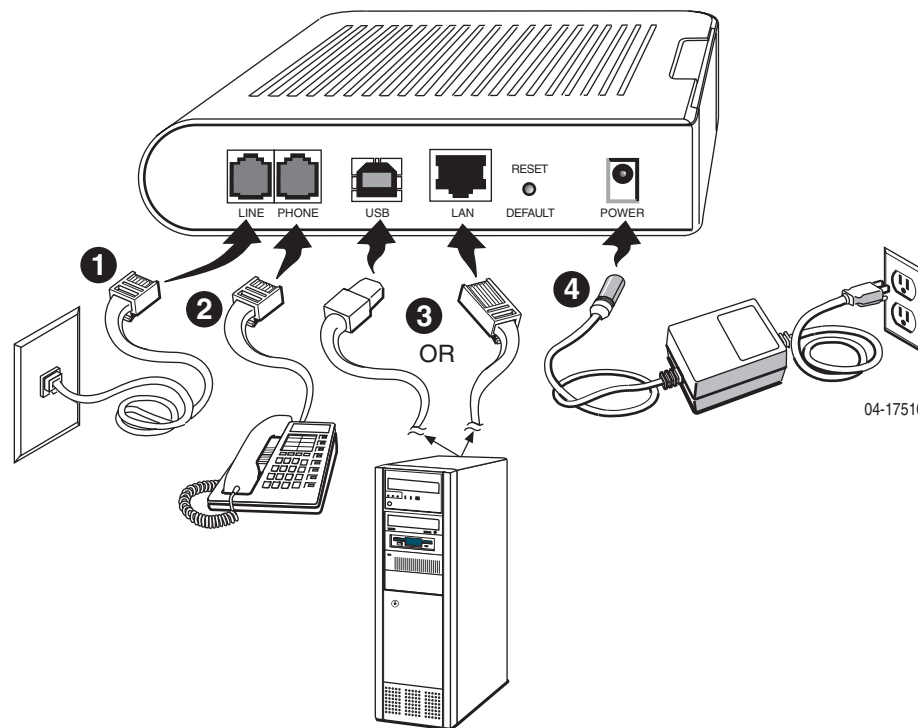

04-17510

See the user's guide on the CD for important safety instructions and more information.



\*6211-A2-GZ10-10\*