



## **Welcome to Talk America's DSL Service**

We at Talk America are excited to offer you a fresh new alternative in high-speed Internet services. The reason we're different is because we built a phone company that's designed around you, allowing us to save you money and deliver award-winning customer service that the others simply can't match.

### **About Your DSL Kit**

This DSL kit contains everything you need to start using your new high-speed DSL service today. Included in this package you will find:

- Your new DSL modem and power supply
- Three filters that you will need to use on your existing telephones
- A CD-ROM with more detailed installation instructions and information about your new DSL modem
- Several cords that may be necessary for installation of your modem

If you have any questions or need further assistance installing your new DSL service, please email us at [CS@talk.com](mailto:CS@talk.com) or call us at 1-800-291-9699 and a Customer Service representative will assist you.

Sincerely,

Ed Meyercord  
Chief Executive Officer, Talk America

# Installing the Router

If there is a telephone installed where you will connect your router, disconnect the telephone from the wall.

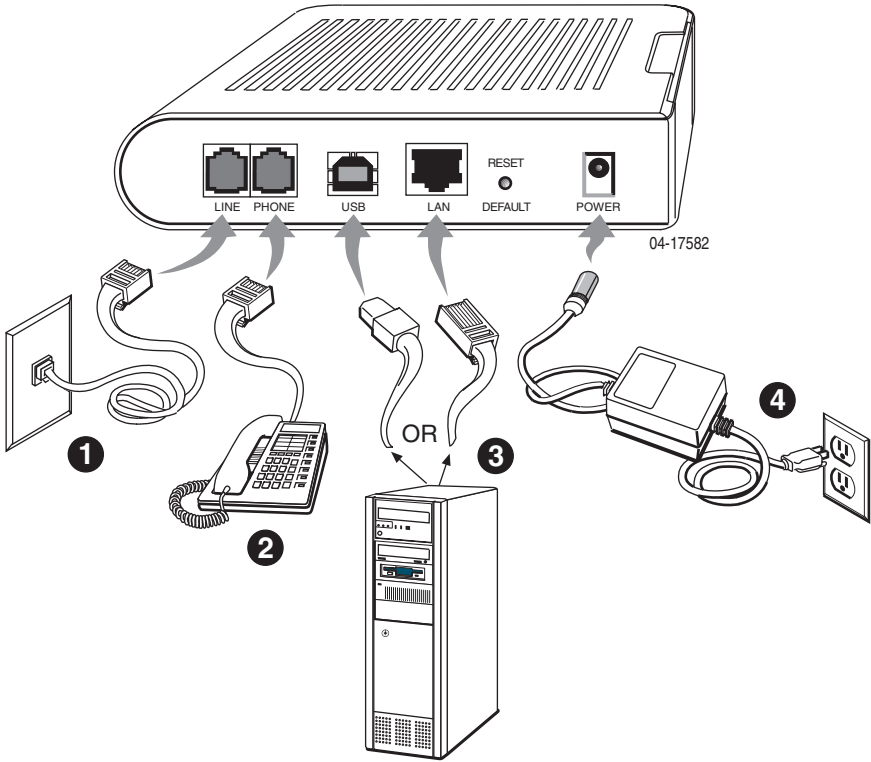

## ► Procedure

To install the router:

1. Connect the LINE port of the router to your DSL line using the supplied phone cord.
2. Connect the PHONE port of the router to your telephone using the cord that came with your telephone. No filter is required.
3. Connect the USB or LAN port of the router to your PC:
  - Connect the USB port of the router to any free USB port on your PC using the supplied USB cable. Install USB drivers on your PC as described in the user's guide on the CD.
  - or —
  - Connect the LAN port of the router to the network interface card in your PC using the Ethernet cable provided.

If your LAN has more than one computer, you can attach one end of an Ethernet cable to a hub or a switch and the other to the port labeled LAN on the modem. This probably will require an Ethernet crossover cable. See the documentation for your hub or switch.

Do not connect both the USB port and the LAN port to the same PC.

4. Connect the POWER receptacle to the power supply and plug the power supply into an AC wall outlet.

## Installing Phone Filters

Since your DSL connection and telephone connection share the same wires, DSL can cause audible noise on your telephones. This noise can also affect other devices that use the phone lines, such as answering machines, alarm systems, and fax machines.

To prevent noise, use phone filters to separate the DSL and voice signals.

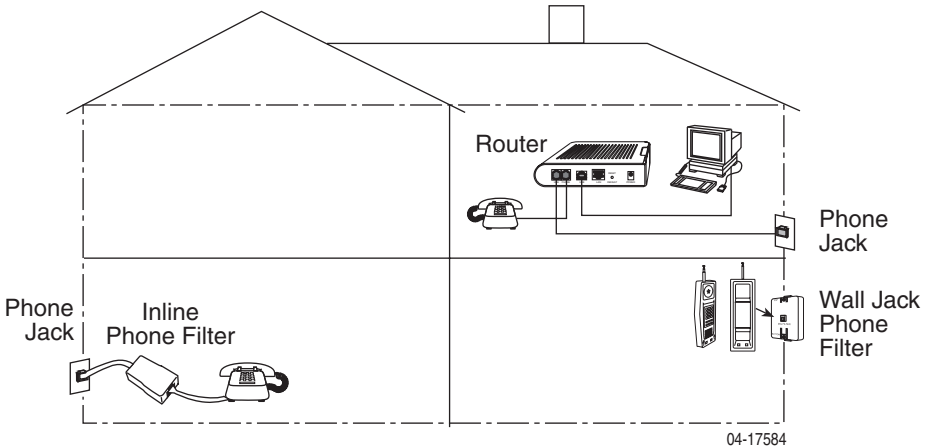

## Wall Jack Phone Filters

Wall phones (phones that are supported by the wall jack they are connected to) can use a wall jack phone filter.

### ► Procedure

To install a wall jack phone filter:

1. Remove your telephone from the wall by lifting it off the support pins and disconnecting it from the jack.
2. Pull out the locking tabs from the top and bottom of the filter so that they are fully extended.
3. Insert the phone plug of the filter into the wall jack.

4. Place the filter over the support pins of the wall jack.
5. Push the locking tabs into the filter until they snap in place.
6. Reinstall your telephone.

The wall jack phone filter has a DSL jack. You can optionally connect the LINE port of your router to this jack instead of using a wall jack. See [Step 1](#) of the procedure under *Installing the Router*.



## Inline Phone Filters

Desktop telephones and devices other than wall phones (such as answering machines, alarm systems, and fax machines) can use inline phone filters.



### ► Procedure

To install an inline filter:

1. Disconnect the telephone (or other device) from the wall jack.
2. Plug the inline phone filter into the wall jack.
3. Plug the telephone (or other device) into the inline phone filter.



\*6211-A2-GZ70-10\*

December 2004