



## SuperLine™ IAD Quick Installation Model 6512-A2

Document Number 6512-A2-GL70-00

June 1999

### Quick Installation for One Extra Phone Line

If you are adding two extra phone lines, see the other side of this page.  
If you are adding one extra phone line, follow these steps:

- 1 Go to the room where you want your new phone line. Plug the phone cord that came with the SuperLine IAD into the wall jack. Plug the other end of the phone cord into the LINE jack on the back of the SuperLine IAD.
- 2 Plug your phone into the PHONE 1/2 jack.
- 3 Plug the power supply into the POWER jack and an ac outlet.

See the Installation Instructions for more information.

### Phone Filters

Connect a phone filter to all the other phones in your house.  
(Do not connect a filter to any phone you plug into the SuperLine IAD.)

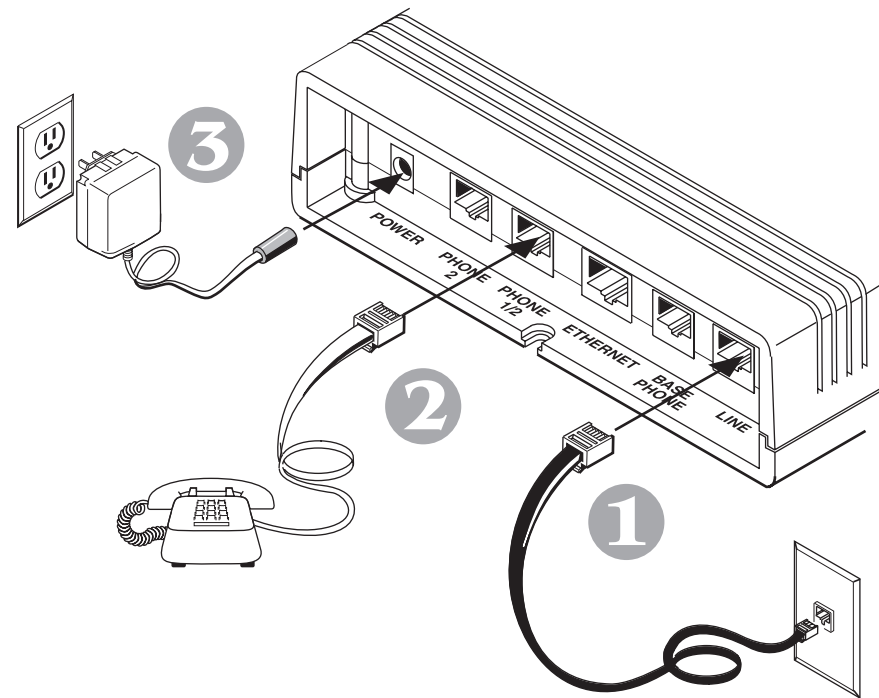

99-16406

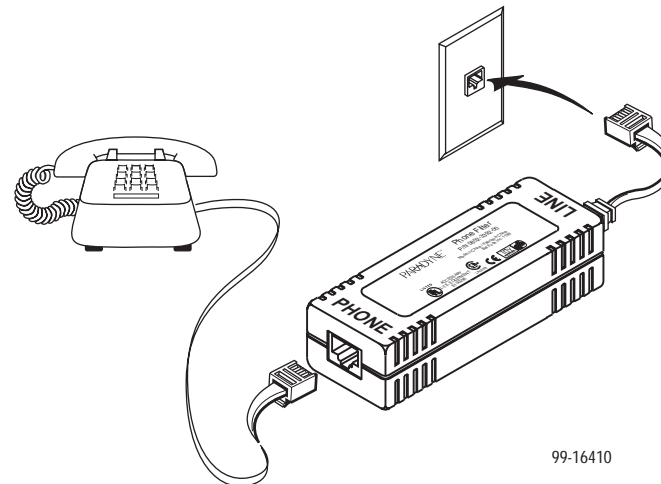

99-16410

## Quick Installation for Two Extra Phone Lines

If you are adding only one extra phone line, see the other side of this page. If you are adding two extra phone lines, follow these steps:

- 1 Go to the room where you want your new phone lines. Plug the phone cord that came with the SuperLine IAD into the wall jack. Plug the other end of the phone cord into the LINE jack on the back of the SuperLine IAD.
- 2 Plug a phone into the PHONE 1/2 jack.
- 3 Plug a second phone into the PHONE 2 jack.
- 4 Plug the power supply into the POWER jack and an ac outlet.

See the Installation Instructions for more information.

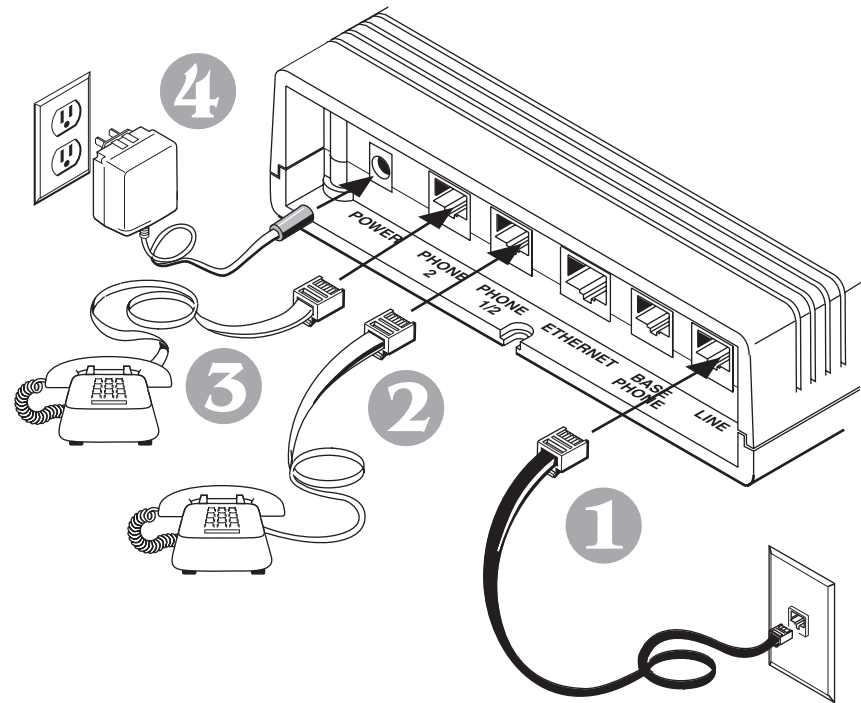

99-16407

## Phone Filters

Connect a phone filter to all the other phones in your house. (Do not connect a filter to any phone you plug into the SuperLine IAD.)

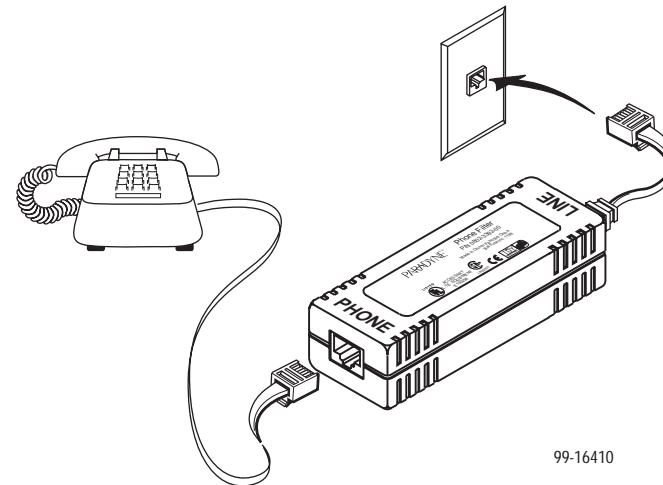

99-16410



\*6512-A2-GL70-00\*